

River Courses

- N 62 1/2 E 76
- N 14 3/4 E 22
- N 38 1/2 E 10
- N 49 E 6
- N 62 E 40
- N 78 E 31
- S 63 1/2 E 25

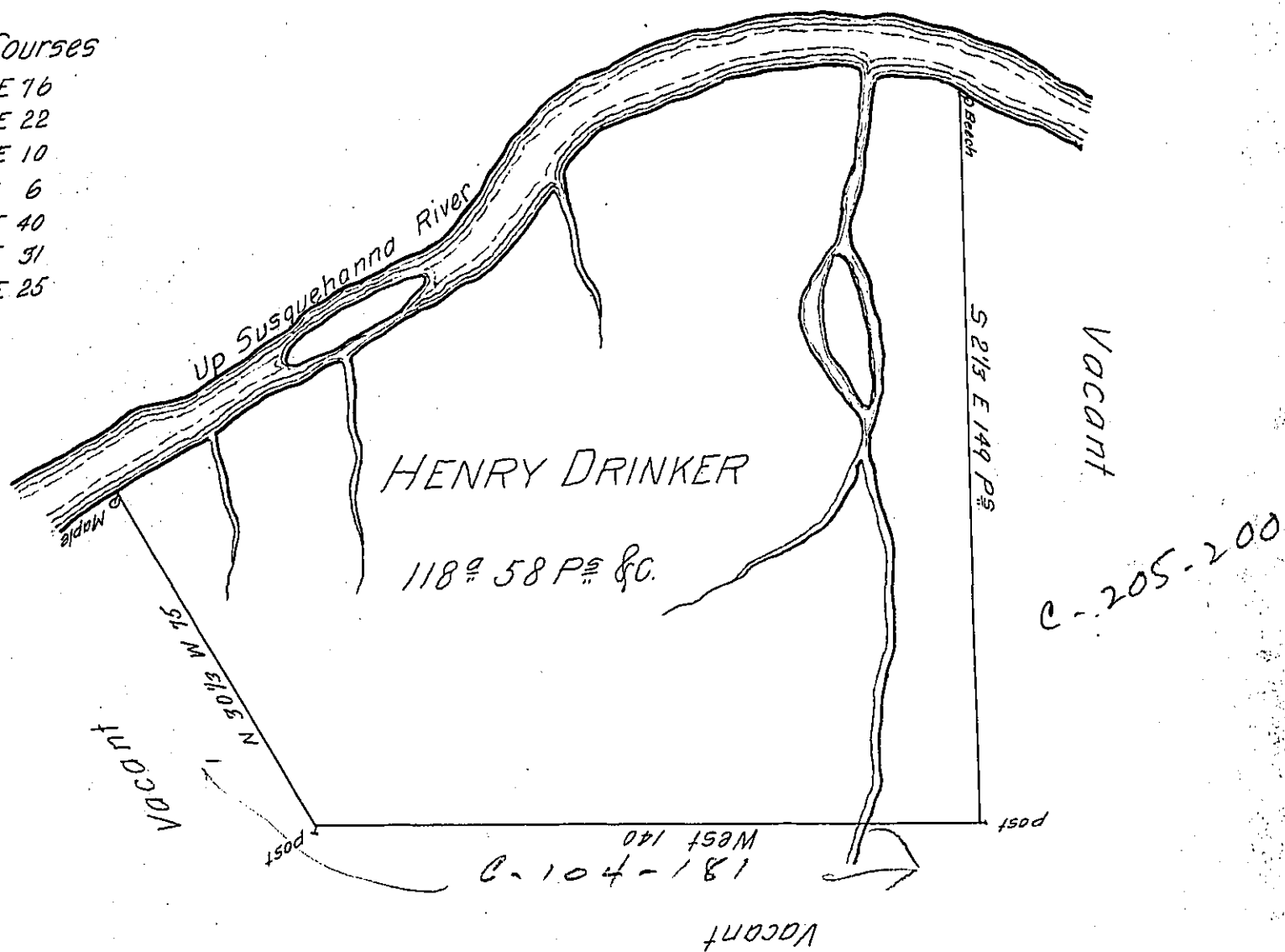

*Draught of One Hundred & eighteen Acres & fifty eight Perches of Land Situate on the South side of the great Bend of the river Susquehanna including the first Bottom & mouth of the first large run below the Mouth of Coneweta Creek in the County of Luzerne Surveyed for Henry Drinker by Virtue of a Warrant Dated the 13<sup>th</sup> Day of December 1788. Surveyed November 19<sup>th</sup> 1793.*

*Anty Crothers D.S.*

*To Daniel Brodhead Esq.  
Surv<sup>r</sup> Gen.*

*IN TESTIMONY that the above is a copy of the original remaining on file in the Department of Internal Affairs of Pennsylvania, made conformably to an Act of Assembly approved the 16th day of February, 1833, I have hereunto set my Hand and caused the Seal of said Department to be affixed at Harrisburg, this twentyseventh day of July 1904*

*James D. Brown*  
Secretary of Internal Affairs.